

Treatment of Cast Parts in a Complete Automatic Blasting Process

Advantages:

- **Reduced cycle times = high production**
- **Consistent full production capability**
- **Multiple applications for large or specifically targeted areas**
- **Proven and reliable integration of the systems and components**

Rösler Roboblaster® RROB

- Blasting wheels type Hurricane® (direct driven and with a motor output up to 22 kW)
- Mobile nozzles as an alternative for "hard-to-reach" areas
- Robotic gripper adaptable to different surfaces of workpieces
- Air-tight, mechanical-free sealing system
- Wet or dry filter unit depending on the application

Common applications include engine blocks, cylinder heads, crankshafts, etc. made of steel, aluminium, magnesium, etc.

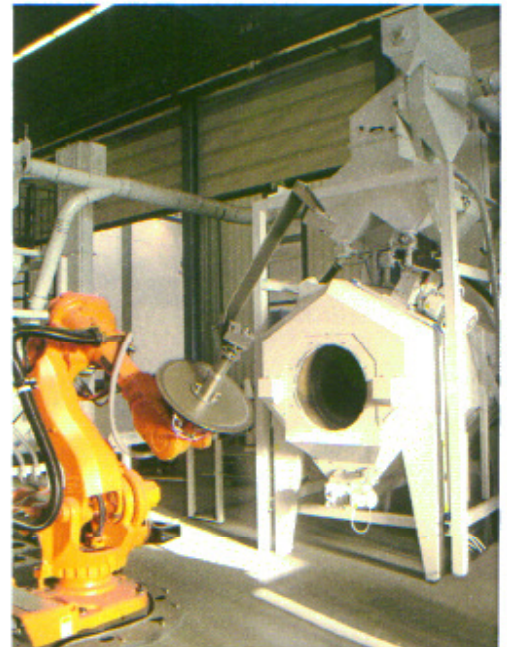

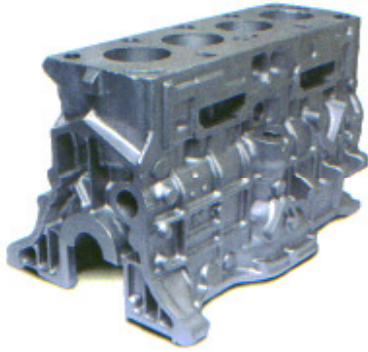

The blasting of highly sensitive or heavy workpieces requires know-how, capability, and experience as well as technically sophisticated and adaptable machines and processes.

The main objective is achieving short cycle times, without compromising consistent quality and reliability. Until recently, the best results had been attained by using Over-Head-Rail Blasting units. Rösler has found the solution with the Roboblaster.

The Rösler Roboblaster offers several advantages. The cycle times can be reduced to a minimum. With its precision gripper, the robot accurately picks the parts from a conveyor and positions them in the blasting cabinet before placing the parts on another conveyor. All this is done with accuracy, speed and reliability.

All machine parts in contact with blasting media are made of high quality wear-resistant manganese steel plates, therefore limiting maintenance and ensuring long life of the unit.

Optionally, the blasting unit can either be equipped with blasting wheels of high performance or with mobile blasting nozzles. The nozzles are best-suited for the treatment of „hard-to-reach“ areas.

The air-tight sealing system and the precision robotic positioning of the workpieces guarantee a perfect and consistent blasting result. The gripper's sixth stage rotation ensures a virtually media-free workpiece after the blasting process, saving time and clean-up.

The integration between robot and other process components is absolutely trouble-free. With the untreated workpieces in the correct position, the remaining tasks can be efficiently accomplished by the robot in full automatic mode.

This is an important advantage compared to other machine types.

Rösler designs, manufactures, and supports complete customer specific process solutions including machine components, media, and after-sales parts and service.

For further information contact:

Rösler Oberflächentechnik GmbH, Vorstadt 1, 96190 Untermerzbach, Germany

Contact person: Mr. Frank Herbst

Phone: +49 9533 924 505, Fax: +49 9533 924 601

E-mail: f.herbst@rosler.com

www.rosler.com